



32 Eucalyptus Court Picnic Point NSW

This beautifully presented home is ideally located moments from the banks of The Georges River and within the highly sought after Picnic Point Primary School catchment.

Offering a low maintenance lifestyle close to all amenities, this home will appeal to a broad range of buyers and certainly generate a great deal of interest.

Offering:



- 3 generous bedrooms with built-in robes and ceiling fans
- Master suite with split system A/C, walk-in robe, ensuite and balcony
- Modern kitchen with stone benchtops, ample storage and adjacent dining
- Two living spaces, both with split system A/C
- Generous main bathroom with bath and shower + separate toilet
- Internal laundry + separate 3rd toilet
- Downlights and plantation shutters throughout
- Covered alfresco area + low maintenance yard
- Large double garage
- Approx. 2.8km to Revesby Train Station

- Approx. 850m to Picnic Point Public School
- Approx. 1.1km to Picnic Point High School
- Approx. 450m to Picnic Point Café and Shops

Contact Theo or Jenny to arrange your private inspection and avoid missing out.

Exclusively Listed by Alliance Real Estate.

Disclaimer: We have, in preparing this document, used our best endeavours to ensure that the information contained herein is true and accurate to the best of our knowledge, but accept no responsibility and disclaim all liability in respect of any errors, omissions, inaccuracies or mis-statements contained in this document. Prospective purchasers should make their own enquiries to verify the information contained in this document.

3  2  2 



Theo Kalinderidis
02 8112 8852
theo@allianceaust.com.au



Jenny Fisher
02 9771 6115
jenny@allianceaust.com.au

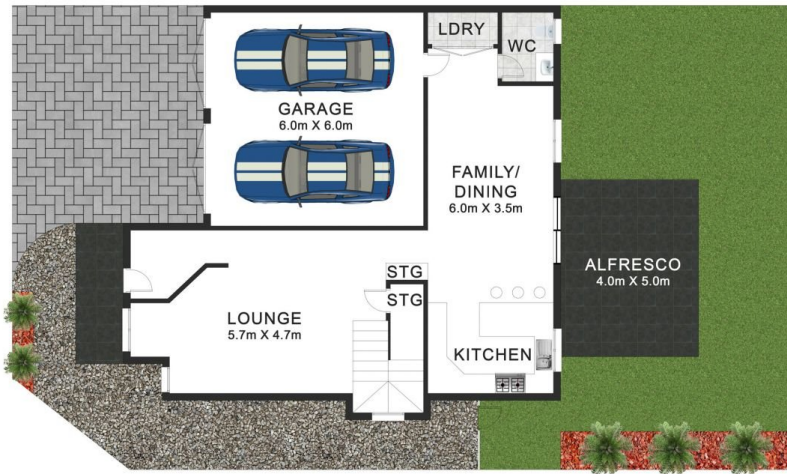

32 Eucalyptus Court, **Picnic Point**

All reasonable care was taken in the preparation of this document, however no warranty is given to the accuracy of the information. Dimensions shown are approximate only.