



### C16/19-21 Marco Avenue Revesby NSW

Situated in the heart of Revesby in the well-known Abbey complex this split-level apartment will certainly be of interest to investors and homeowners.

This freshly painted and carpeted apartment features 2 spacious bedrooms with built in wardrobes with access to the balcony and a large main bathroom and internal laundry.

Upstairs you have a very large living area and a modern kitchen that features dishwasher as well as access to a 2nd covered balcony that allows for entertaining and has commanding views of Revesby and enjoys plenty of sunlight year-round with its north facing aspect.



With 2 split system reverse cycle air conditioners, security intercom, lift access and underground parking this property is simply too good to be ignored.

- ? Split level - 2 floor 2-bedroom Apartment with built ins
- ? Modern Kitchen with stone bench tops and dishwasher
- ? Modern bathroom & internal laundry
- ? Open Plan Living and Dining
- ? Secured complex and underground parking

- ? North facing balconies
- ? Just 250m to Revesby Train Station
- ? In the heart of the Revesby shopping precinct with shops and cafe's right on your doorstep
- ? Only 500m distance to the Revesby Workers Club

Exclusively Listed by Alliance Real Estate.

Disclaimer: We have, in preparing this document, used our best endeavours to ensure that the information contained herein is true and accurate to the best of our knowledge, but accept no responsibility and disclaim all liability in respect of any errors, omissions, inaccuracies or mis-statements contained in this document. Prospective purchasers should make their own enquiries to verify the information contained in this document.

2  1  1 

Price : \$ 600,000



**Andrew Prodromou**  
**02 9771 6115**  
andrew@allianceaust.com.au



**Rema Fakhoury**  
**02 9771 6115**  
rema@allianceaust.com.au

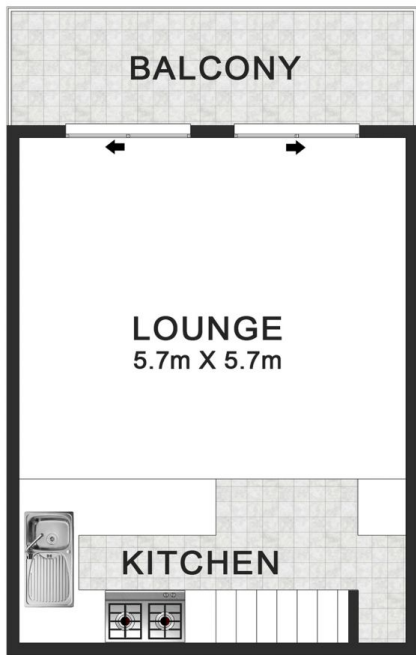

UPPER LEVEL

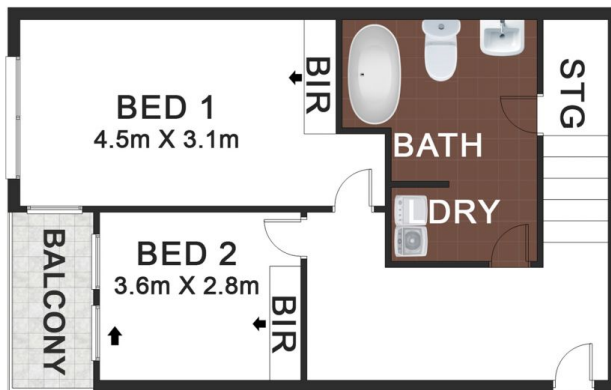

ENTRY LEVEL

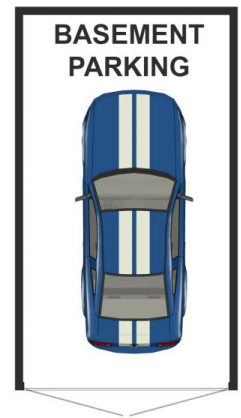

C16/19-21 Marco Avenue, **Revesby**

All reasonable care was taken in the preparation of this document, however no warranty is given to the accuracy of the information. Dimensions shown are approximate only. floorplan by [www.opticoolestudios.com](http://www.opticoolestudios.com)