



## 21 Flanders Avenue Milperra NSW

This incredibly stylish updated family home boasts an impressive back yard that's been thoughtfully designed to take advantage of the sparkling in-ground pool complete with water features. As you step through the sliding glass doors onto a timber deck of impressive proportions you are met with alfresco living at its best. An entertainer delight this outstanding family home is truly a suburban oasis.

This unique 5-bedroom home with built-in robes is perfect for the growing family.

Featuring a large modern timber kitchen with quality gas appliances, two fully updated bathrooms and a family conveniently overlooking the glorious back yard.

An enclosed carport with remote controlled roller door, ducted Airconditioning and alarm system are just a few of the added features this amazing family home has to offer.

Situated within a short walk to transport, shops and the University of Western Sydney, this property is sure to impress.

We Love:



- Sparkling in-ground pool
- Family room overlooking backyard

- Walk to shops, transport and University

Pluses:

- 5 bedrooms
- Kitchen with gas cooking
- Enclosed carport with remote door

Disclaimer: We have, in preparing this document, used our best endeavours to ensure that the information contained herein is true and accurate to the best of our knowledge, but accept no responsibility and disclaim all liability in respect of any errors, omissions, inaccuracies or mis-statements contained in this document.

5  2  1 



**Courtney Peterson**

**02 9771 6115**

**[courtney@allianceaust.com.au](mailto:courtney@allianceaust.com.au)**



21 Flanders Ave,  
**Milperra, NSW**  
Floorplan & Siteplan  
(siteplan not to scale)

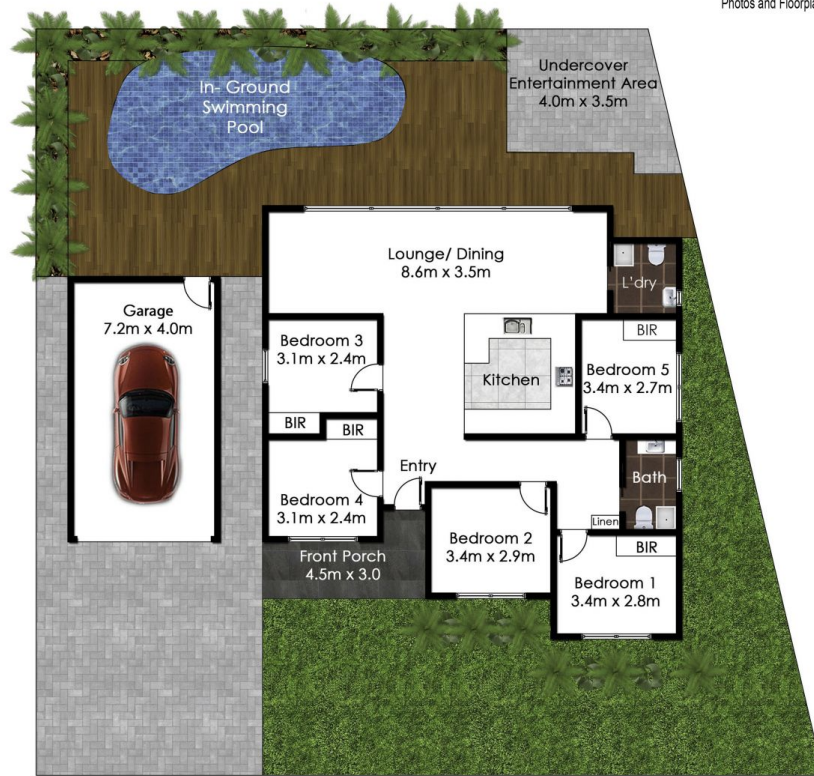

This diagram is for illustrative purposes only. All reasonable care has been taken in the preparation, but no warranty is given to the accuracy of the information. This document does not constitute any part of any offer or contract. Dimensions shown are approximate only. Prospective purchasers must rely on their own enquiries. Photos and Floorplan by [www.opticoolstudios.com](http://www.opticoolstudios.com)